

COUNTRY LAKES



The Morgan Quick Move-In!

\$294,062
9308 Meadowpark Dr.
Argyle, Texas
76226



The Morgan plan in Country Lakes' newest phase is perfect for your growing family or empty nesters. As you enter the foyer, the Dining Room greets you and opens to the Kitchen and large Great Room overlooking the Covered Patio perfect for entertaining. The luxurious Master Retreat has a large walk-in closet and garden tub for relaxing away. Spacious bedrooms 2 and 3 with a shared full Bath round out this beautiful home.

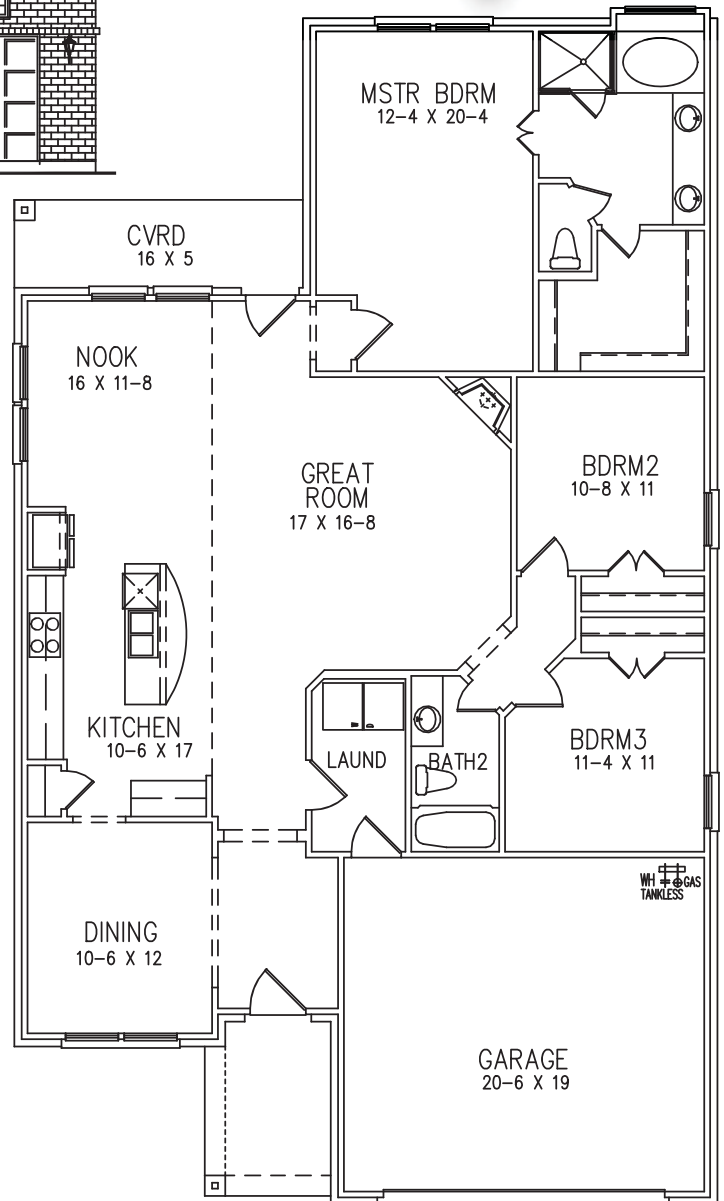

-  **3 / 2 / 2**
-  **1,850 Sq Ft**
-  **Stainless Steel Appliances**
-  **Upgraded Maestro Quartz Kitchen Countertops**
-  **Custom site finished cabinetry**
-  **Wood floors throughout Entry, Kitchen and Great Room**
-  **Covered Patio**
-  **Energy Efficient A/C**
-  **Energy Efficient Tankless Water Heater**
-  **And much more!**

For more information, call your Listing Agent
Jollete Ryon-Schoeve 817.832.8583
Jollete@NorthTexasTeam.com

www.InnovationBuilders.com

Price refers to the lowest base price and does not include any options that may be shown. Price, floor plans, elevations and features will vary based on location of community. Pricing and plans are subject to change at any time. Actual square footage and dimensions will vary. 12/13/2018

